

Metal Stud Crete® Composite System

NOTE: CONNECTION OF CONTINUOUS BOTTOM AND TOP TRACK TO CONCRETE FACING IS ACHIEVED WITH SAME MetalStudCrete FLANGE COMPOSITE CONNECTOR (ALSO APPLIES AT HEADER CONDITIONS)

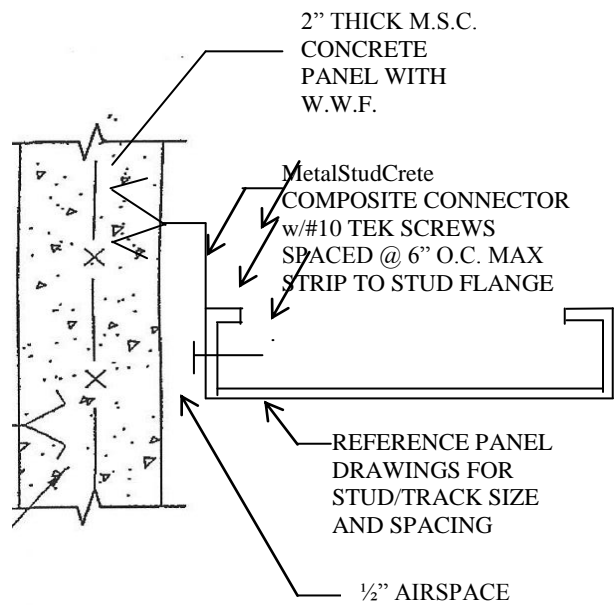

5
MC10

M.S.C. TRANSFER STRIP @ STUD/TRACK FLANGE

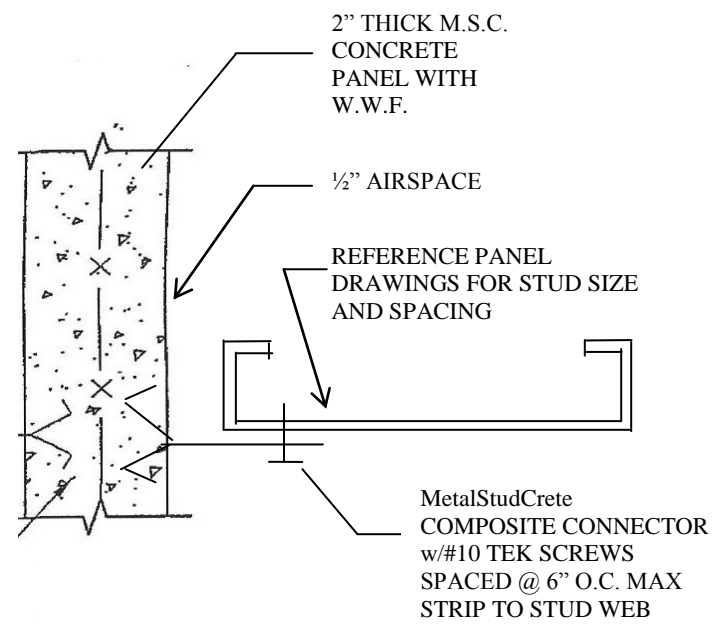

6
MC10

M.S.C. TRANSFER STRIP @ STUD WEB

For further details on Metal Stud Crete® contact Composite Building Systems Inc.
E-mail: info@metalcrete.com
Website: www.metalcrete.com
Phone: (818) 606-4703